

Second Hand Ground Support Bühne GSH 300

Baujahr/*Construction year*: 2002

Features: Ground Support Bühne mit Anbauten | *Ground Support Stage with extensions*

Zubehör/*Extras*: 2 Treppen, Rampe | *2 stairs, ramp*

Zustand/*Condition*: OK | *OK*

Preis/*Price*: auf Anfrage | *please ask us*

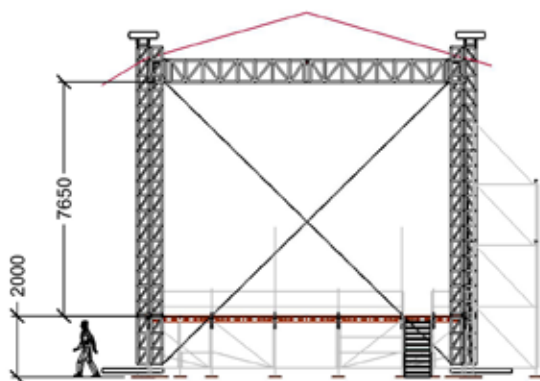
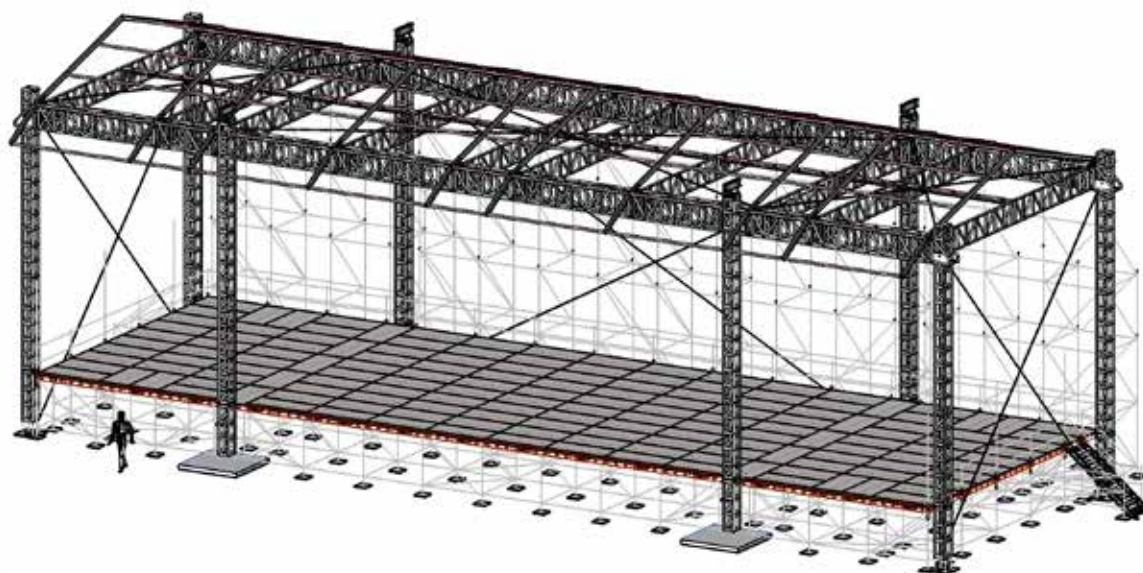

		Podium/Podium	Dach/Roof
Breite	Width	31,08 m	31,08 m
Tiefe	Depth	10,36 m	12,43 m
Lichte Höhe vorne	Clearance front		7,65 m



